

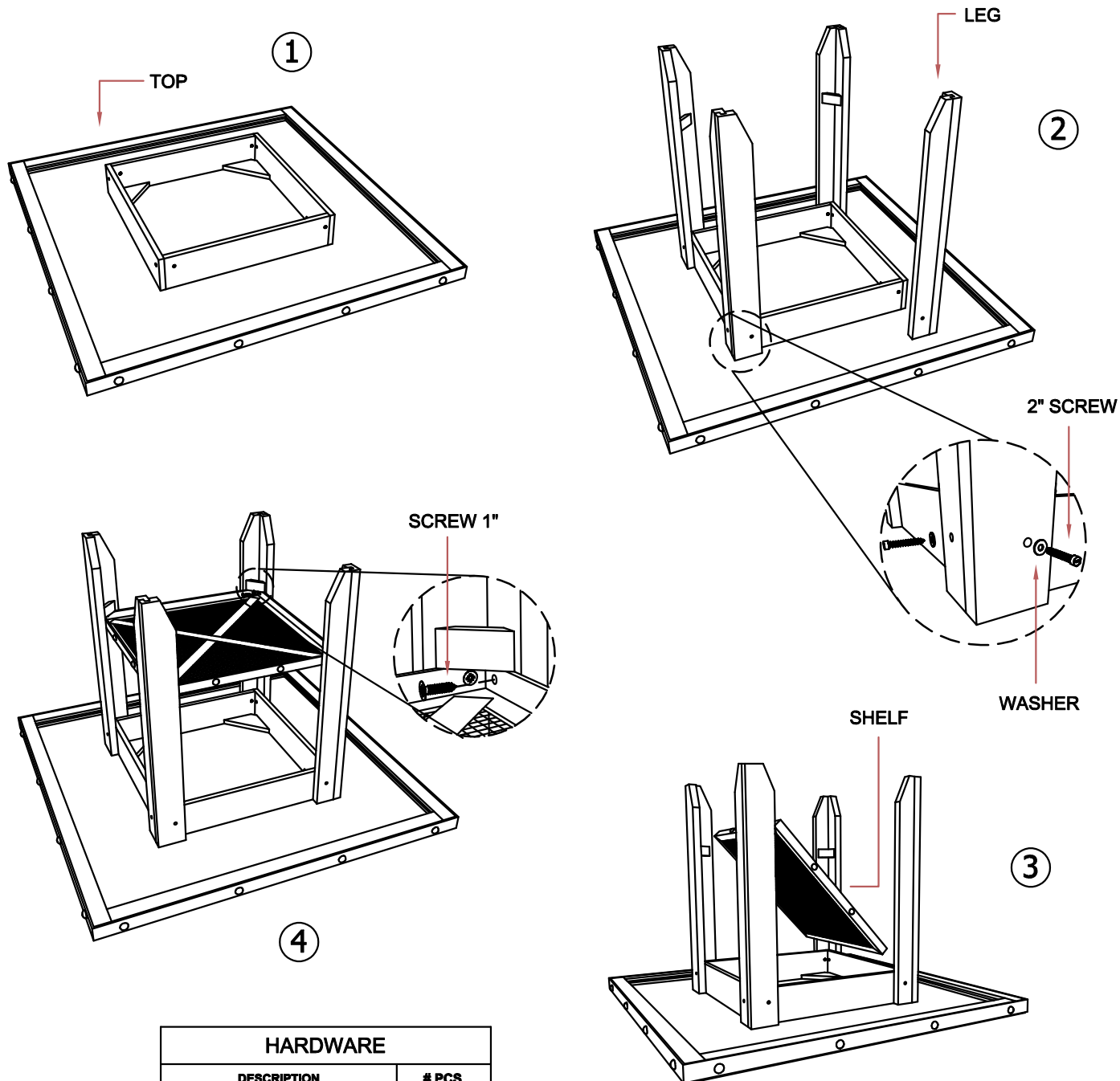

# ASSEMBLY INSTRUCTIONS

I-CNT-C002-BN

PRODUCT IMAGE SHOWN IS FOR ILLUSTRATIVE PURPOSES ONLY, SHOULD NOT BE TAKEN AS REFERENCE POINT



HARDWARE	
DESCRIPTION	# PCS
HEX BOLT 5/16 x 2"	8
WASHER 5/16"	8
LOCK WASHER 5/16"	8
FLAT HEAD SCREW 8 x 1"	8

## INSTRUCTIONS:

- 1.- USE A FLAT AND CLEAN SURFACE FOR ASSEMBLY
- 2.- PLACE EACH LEG IN THE CORRECT CORNER, MATCHING THE SCREWS TO THE PRE-DRILLED HOLES.
- 3.- INSERT THE SCREWS, PLACE THE NUTS AND MAKE SURE THE LEGS ARE COMPLETELY STRAIGHT.
- 4.- WITH HELP, PLACE THE SHELF AND SCREW EACH LEG AS SHOWN IN DRAWING.
- 5.- TIGHTEN THE CORRESPONDING SCREWS.
- 6.- WITH SOMEONE ELSE'S HELP, PLACE THE TABLE IN THE DESIRED PLACE