

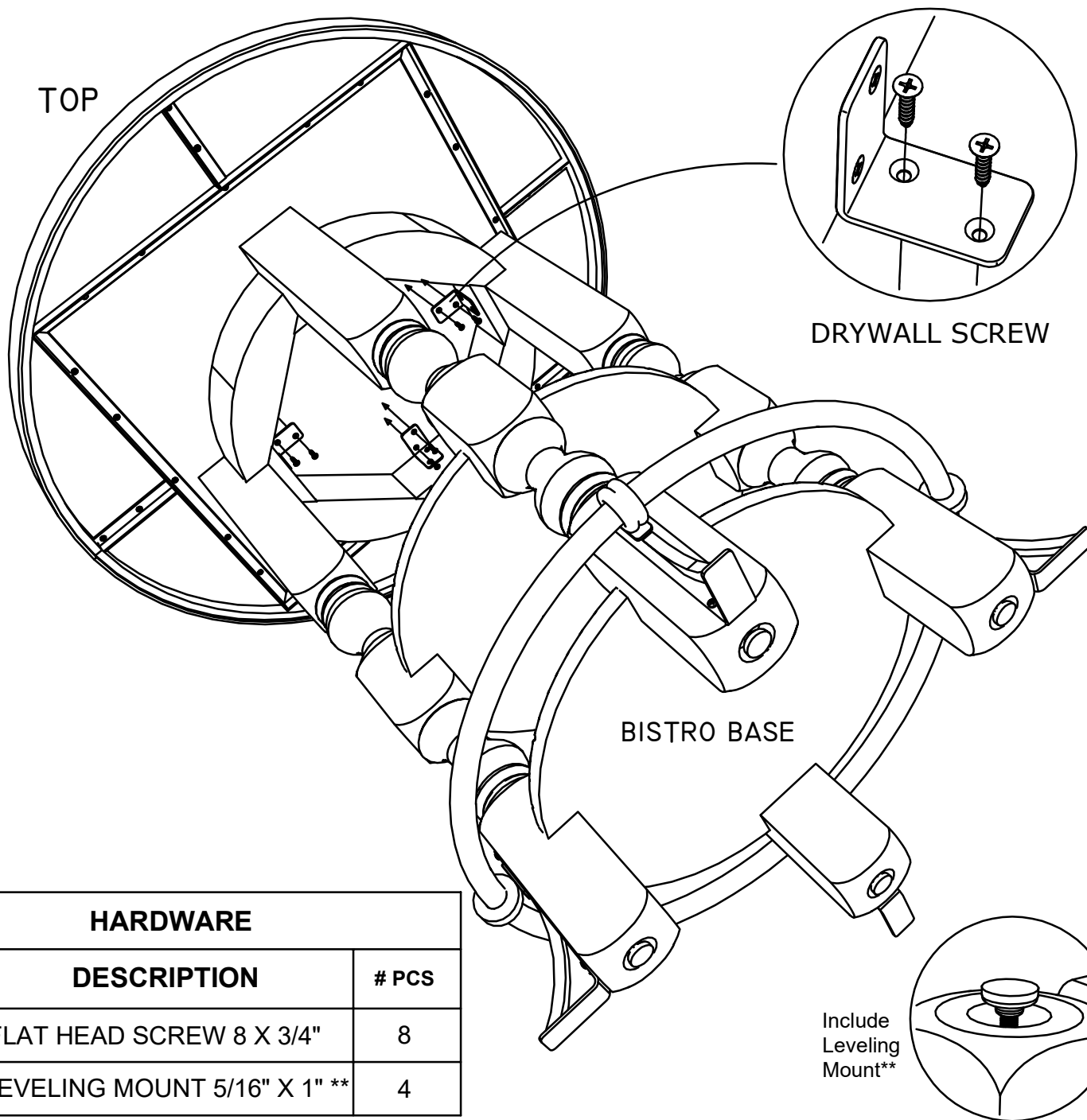

# ASSEMBLY INSTRUCTIONS

I-BIS-C001

PRODUCT IMAGE SHOWN IS FOR ILLUSTRATIVE PURPOSES ONLY, SHOULD NOT BE TAKEN AS REFERENCE POINT



HARDWARE	
DESCRIPTION	# PCS
FLAT HEAD SCREW 8 X 3/4"	8
LEVELING MOUNT 5/16" X 1" **	4

\*\*APPLIES TO SOME PRODUCTS

## INSTRUCTIONS:

- 1.- WITH SOME ONE ELSE'S HELP, PLACE THE TOP UPSIDE DOWN ON A FLAT AND CLEAN SURFACE.
- 2.- PLACE THE BASE OVER THE TOP AND CENTER IT.
- 3.- ATTACH THE BASE FROM THE BOTTOM TO THE TOP WITH THE DRYWALL SCREWS.
- 4.- TURN THE BASE OVER AND PLACED IN THE DESIRE LOCATION.